

NOTES:

1. INSTALLATION TO BE COMPLETED PER MANUFACTURER'S SPECIFICATION.
2. REFER TO TrexFencingFDS.com FOR CONSTRUCTION DETAILS AND PRODUCT INFORMATION
3. DRAWING NOT TO SCALE.

COMPONENT		QTY.	LENGTH	COMPONENT		QTY.	LENGTH
Post Cap		1	N/A	Bottom Rail / Picket		2	91"
Post		.5	108"	Aluminum Bottom Rail		1	90 1/2"
Top Rail		1	91"	Fence Bracket		4	N/A
Picket (Cut to 19 1/2")		6.3	67"	Ext. Wood Screw		22	1 5/8"

Component lengths may vary

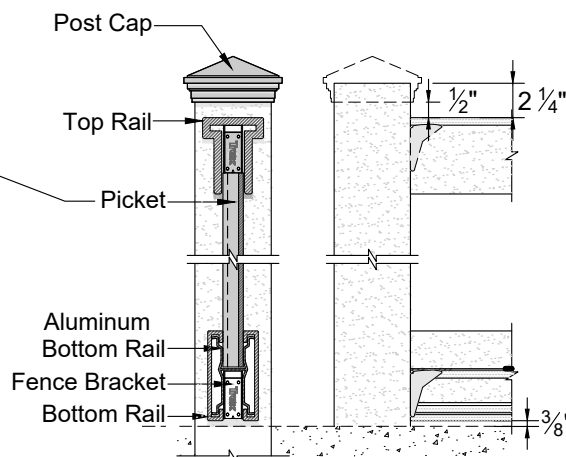
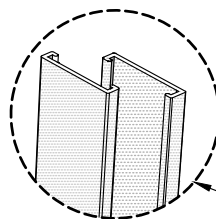

CUT VIEWS

010923